

# Mecca Wall-Mounted Sensor Tap With 80mm Wall Plate

# Nero

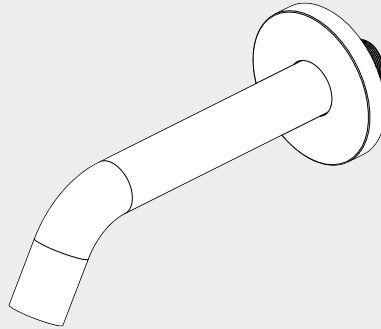

Lead Free



Versions:202506



## Drawing

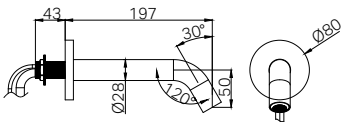

## Features

### Watermark License

WM-060073

### Temperature Rating

Min 1°C - Max 75°C







### Pressure Rating

Min 150kpa - Max 500kpa

## Packaging Includes

1x Sensor Tap  
1x Power Adapter  
1x Solenoid  
4x AA Batteries

## Finish & SKU

- |  |   |   |   |
|--|---|---|---|
|  Chrome<br>NR405CH      |  Gun Metal<br>NR405GM    |  Brushed Bronze<br>NR405BZ |  Brushed Nickel<br>NR405BN |
|  Matte Black<br>NR405MB |  Brushed Gold<br>NR405BG |  Matte White<br>NR405MW    |   |

\*Dimensions are nominal measurements only.

## INSTALLATION INSTRUCTIONS

### GENERAL INSTRUCTIONS

- This product must be installed by a licensed plumber. Ensure that your plumbing installation complies with the Australian/New Zealand Standard AS/NZS 3500.
- All pipework must be thoroughly flushed prior to the installation of the mixer. In-line filters must be fitted on both hot and cold supplies to prevent foreign particles from damaging the ceramic cartridge.
- All outlets used primarily for personal hygiene must deliver water at a safe temperature in accordance with regional regulations.

### NOTE:

- After installation, all connections must be checked for leaks.
- This mixer is not recommended for use in uncontrolled heating systems such as wet-backs or solar heating units unless a suitable tempering valve is fitted.
- If limited water flow is experienced, locate aerator and filter washers and clean away foreign material as required.
- It is the responsibility of the plumber to ensure a waterproof seal is achieved between the product and mounting surface. If in doubt about the quality of the seal, remove the product and reinstall.

### INSIDE THE BOX

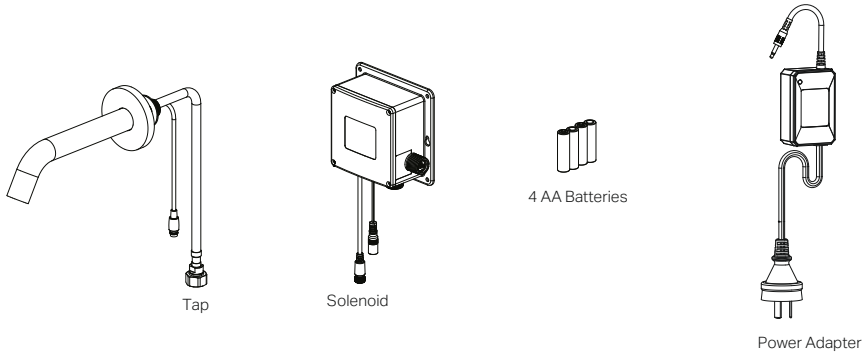

### 01. DRILL HOLES

- Drill holes in the wall as shown in the diagram.

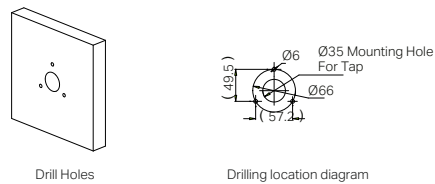

### 02. INSTALL TAP

- Pass flexible hoses and sensor cable through the mounting hole, fix the tap with expansion plugs and self-tapping screws.
- **OPTIONAL:** The locking nut allows users to secure the tap from the wall's rear side.
- Engage the wall plate.

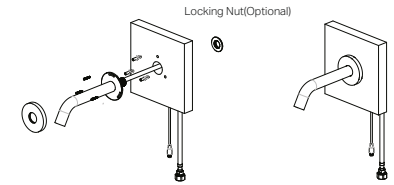

### 03. INSTALL BATTERIES

- Open the solenoid, remove the battery tray, and insert 4x AA batteries as shown.

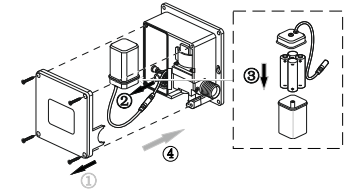

### 04. INSTALL SOLENOID

- Drill holes in the wall as shown in the diagram and install the solenoid (Note the correct installation orientation of the solenoid).

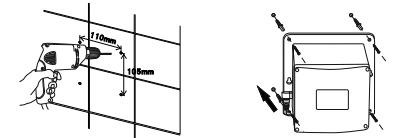

- NOTE:  
The recommended installation height of solenoid.

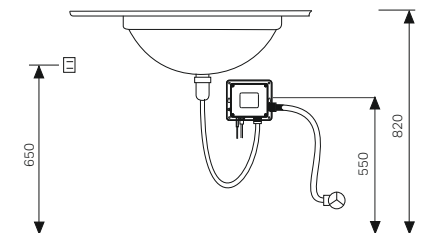

## 05. WATER AND CABLES CONNECTION

- Connect all hoses and signal/power cables as shown. Ensure all joints are firmly secured and there are no leaks before turning on the water supply.

### Water Connection

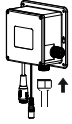

**1. Water Outlet Hose Connection**  
Connect the hose from the tap to solenoid.

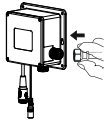

**2. Water Inlet Hose Connection**  
Connect G1/2 water supply hose to water inlet

Note: Ensure there is no water leakage after connecting the water supply.

### Signal Cable Connection



Connect signal cable and power cable to solenoid.  
Note: Keep the cables clear and dry.

## 06. COMPLETED INSTALLATION DIAGRAM

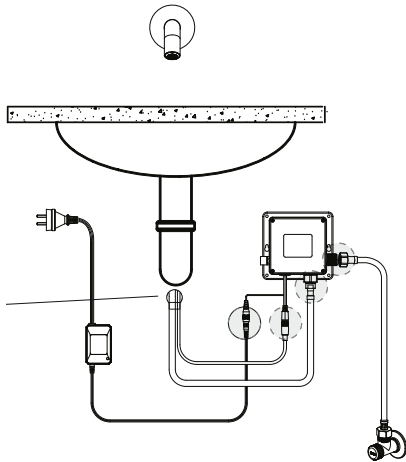

NOTE: Drill a access hole beneath the basin to facilitate power and water line connections between the solenoid and sensor tap.

## 07. ADJUST THE SENSOR DISTANCE

The sensor distance is preset at 8–10cm as measured. If adjustment is needed, press the red button on the solenoid for 2 seconds. Move your hand to the desired distance. The red light will blink and stop, confirming the new setting.

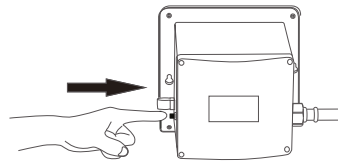

## 08. SERVICE AND MAINTENANCE (ROUTINE MAINTENANCE)

- Wipe the sensor window with a soft cloth if it is not working properly.
- Replace the batteries if needed (if the red light blinks in the sensor window).
- Use a soft cloth to clean the tap—do not spray water directly onto the tap.

## 09. TROUBLESHOOTING

ISSUES	OBSERVED SYMPTOMS	POSSIBLE CAUSE	SUGGESTION
	The sensor doesn't light up	Batteries installed the wrong way	Double-check the battery direction and make sure the battery compartment is assembled correctly.
		Loose or incorrect cable connections	Reconnect all cables properly — including transformer, battery pack, sensor, solenoid.
		No power supply(AC mode)	Make sure the power outlet is working.
		Cables damaged	Check and reconnect the cables or contact Nero support.
		Sensor not detecting	Ensure your hand is within the sensor range(5-15cm), or adjust the sensor distance.
No water comes out when activated	The sensor light works	Water supply is off	Check that the isolation valve (mini stoppers) is fully open and water is available.
		Solenoid not working	Test the solenoid and check the cable connections
		Blocked filter	Take out the filter and clean or replace it if needed.
		Lighting or reflective surface interference	Adjust sensor distance or lighting if possible.
		Solenoid blocked	Clean the solenoid port.
		Sensor light is flashing	Low battery
Water keeps flowing after use		Detection range not suitable	Reset or adjust the sensing distance.
Weak or slow shut off		Solenoid dirty	Clean the solenoid valve area.
		Low water pressure	Check household plumbing or consult a licensed plumber.
Sensor turns on/off randomly		Sensor picks up too far	Adjust the sensor distance to match your installation.
		Nearby reflections or bright lights	Avoid mirrors or shiny objects near the sensor and keep it away from direct light.

Nero



Warranty Policy